

CONSTRUCTION NOTES:

1. MOUNDS SHOULD BE CREATED WITH LEAN TOP SOIL.
2. SWALE IS LINED WITH 3'-4' DIAMETER MOSSY SONOMA FIELDSTONE BOULDERS AND FILLED WITH 2" MAXIMUM ROUND PEBBLE. BOTTOM OF SWALE TO BE FILLED WITH 1' MINIMUM DRAIN ROCK.
3. TREE ROOTS SHOULD BE PROTECTED - IF DIGGING FOR PLANTING RESULTS IN DAMAGE TO ROOTS MOUND SOIL RATHER THAN DIG.

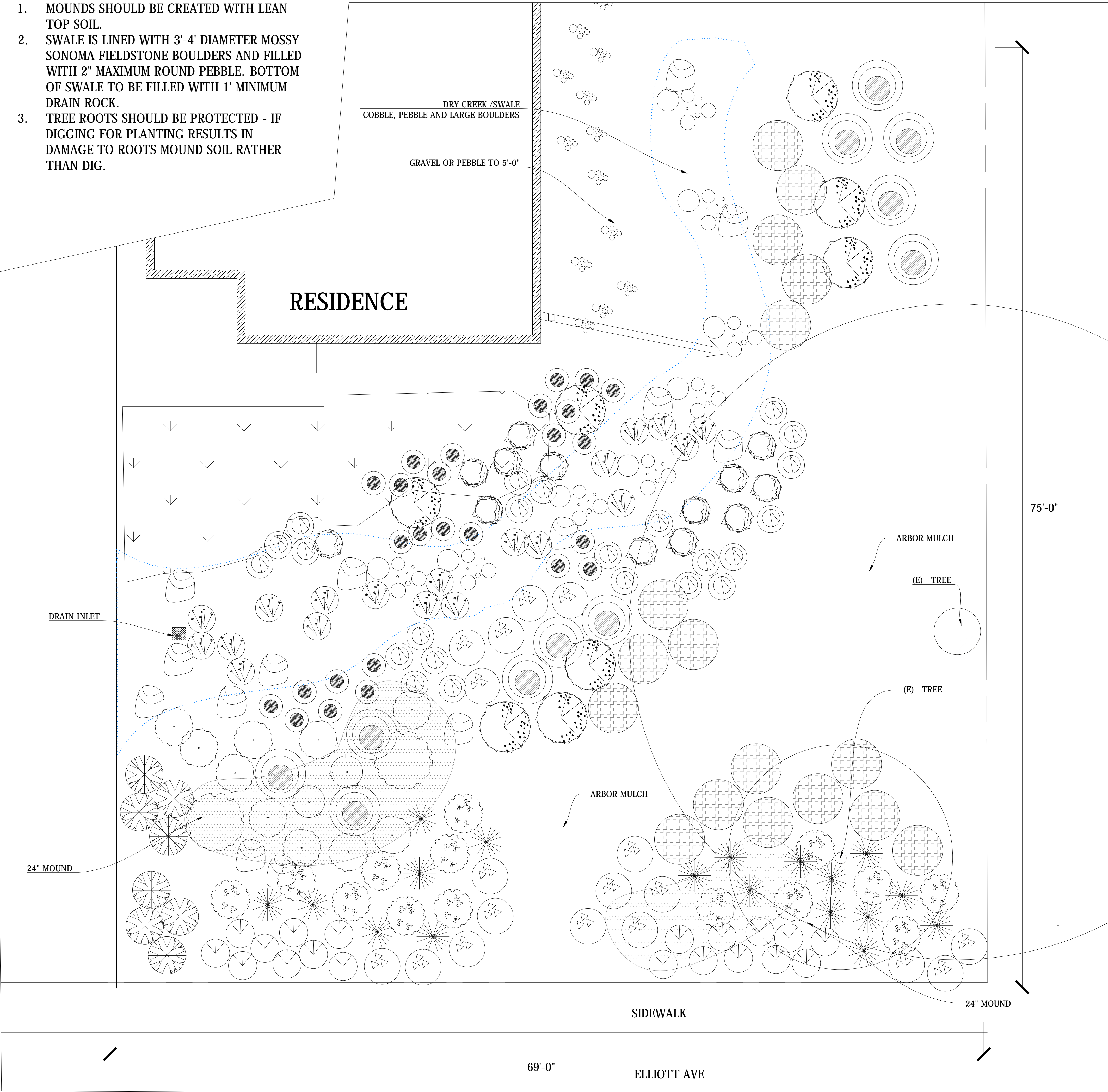

PLANT LEGEND

SYMBOL	BOTANIC NAME	COMMON NAME	SPACING	SIZE	QTY
	BACCHARIS 'TWIN PEAKS'	GROUNDCOVER COYOTE BUSH	6'-8'	1 GAL	17
	CEANOTHUS 'DARK STAR'	CALIFORNIA LILAC	6'-8'	1 GAL	2
	DESCHAMPSIA CESPITOSA	TUFTED HAIRGRASS	2'-3'	4"	18
	EPILOBIUM 'WAYNES SILVER'	CALIFORNIA FUCHSIA	3'	4"	8
	ERIOGONUM 'WARRINER LYTLE'	GROUNDCOVER BUCKWHEAT	4'	1 GAL	18
	FRANGULA 'MOUND SAN BRUNO'	COFFEEBERRY	6'	1 GAL	11
	HEUCHERA MAXIMA	ISLAND ALUM ROOT	1'-2'	1 GAL	26
	IRIS DOUGLASIANA	DOUGLAS IRIS	1.5'-2'	1 GAL	23
	JUNCUS PATENS	COMMON RUSH	1'-2'	4"	19
	MIMULUS 'ELEANOR'	MONKEYFLOWER	1.5'-3'	1 GAL	14
	RIBES 'WHITE ICICLES'	WHITE FLOWERING CURRANT	6'	1 GAL	8
	SALVIA CLEVELANDII	CLEVELAND'S SAGE	5'	1 GAL	10
	SALVIA SPATHACEA	HUMMINGBIRD SAGE	3'-5'	1 GAL	13
	SISYRINCHIUM BELLUM	BLUE-EYED GRASS	1'	4"	19
	SPHAERALCEA INCANA	GRAY GLOBEMALLOW	1.5'-2'	1 GAL	2
	"NO MOW NATIVE MIX" SUPPLIER: DELTA BLUEGRASS SPECIES: FESTUCA RUBRA	RED FESCUE MIX		SOD/PLUG	550 SF

**SYMBOLS IN LEGEND MAY NOT REFLECT SIZE ON PLAN. PLANTING LAYOUT REFLECT FULL COVERAGE IN 3 YEARS.

GENERAL MATERIALS LEGEND FOR SRJC PROJECT

(E) EXISTING	CRUSHED GRANITE PAVING	SLEEVE
G GAS	PEA GRAVEL	DOWN SPOUT
E ELECTRIC	BOULDER - FIELDSTONE MOSSY	RAIN GARDEN FEATURE
W WATER MAIN	BOULDER - SMOOTH TAN	SWALE
	BOULDER - SITTING/CONCAVE TO COLLECT WATER	MOUND
		BENCH
		HOGWIRE FENCE
		CENTER LINE SWALE
		ARROW DENOTES DIRECTION OF FLOW
		CONTINUES

BY USING THESE PLANS, I AGREE TO DEFEND, INDEMNIFY AND HOLD HARMLESS THE SONOMA MARIN SAVING WATER PARTNERSHIP, ITS MEMBERS SONOMA COUNTY WATER AGENCY, CITY OF SANTA ROSA, MARIN MUNICIPAL WATER DISTRICT, NORTH MARIN WATER DISTRICT, CITY OF ROBINET PARK, CITY OF PITTALUMA, CITY OF COVATE, CITY OF SONOMA, VALLEY OF THE MOON WATER DISTRICT AND TOWN OF WINDSOR AND THEIR DIRECTORS, OFFICERS, AGENTS, EMPLOYEES AND LANDSCAPE DESIGN CONSULTANTS AGAINST ANY AND ALL LOSS, LIABILITY, EXPENSE, CLAIMS, SUITS AND DAMAGES, INCLUDING ATTORNEY'S FEES, ARISING OUT OF OR RESULTING FROM THE USE OF THESE LANDSCAPE PLANS. I UNDERSTAND THAT IT IS MY RESPONSIBILITY AS THE PROJECT OWNER TO ENSURE THAT PLAN ELEMENTS ARE IMPLEMENTED SAFELY AND ACCORDING TO APPLICABLE STATUTES, RULES, REGULATIONS, ORDINANCES AND/OR CODES. SONOMA MARIN SAVING WATER PARTNERSHIP, ITS MEMBERS AND LANDSCAPE DESIGN CONSULTANTS MAKE NO REPRESENTATIONS AND GRANT NO WARRANTIES, EXPRESS OR IMPLIED, EITHER IN FACT OR BY OPERATION OF LAW, BY STATUTE OR OTHERWISE, AND SONOMA MARIN SAVING WATER PARTNERSHIP, ITS MEMBERS AND DESIGN CONSULTANTS, EACH SPECIFICALLY DISCLAIM ANY OTHER WARRANTIES, WHETHER WRITTEN OR ORAL, OF EXPRESS OR IMPLIED, INCLUDING ANY WARRANTY OF QUALITY, MERCHANTABILITY OR FITNESS FOR A PARTICULAR USE OR PURPOSE OR ANY WARRANTY AS TO THE VALIDITY OF ANY PATENTS OR THE NON-INFRINGEMENT OF ANY INTELLECTUAL PROPERTY RIGHTS OF THIRD PARTIES.

SOIL NOTES

- SOIL AMENDMENTS, CONDITIONING AND MULCHING.
1. A MINIMUM OF EIGHT (8) INCHES OF NON-MECHANICALLY COMPACTED SOIL SHALL BE AVAILABLE FOR WATER ABSORPTION AND ROOT GROWTH IN PLANTED AREAS.
 2. COMPOST OR NATURAL FERTILIZER SHALL BE INCORPORATED INTO THE SOIL TO A MINIMUM DEPTH OF EIGHT (8) INCHES AT A MINIMUM RATE OF SIX (6) CUBIC YARDS PER ONE THOUSAND (1,000) SQUARE FEET, OR ACCORDING TO SPECIFIC AMENDMENT RECOMMENDATIONS FROM A SOILS LABORATORY REPORT.
 3. A MINIMUM OF THREE-INCH LAYER OF "ARBOR" MULCH SHALL BE APPLIED ON ALL EXPOSED SOIL SURFACES OF PLANTING AREAS EXCEPT IN TURF AREAS, CREEPING OR ROOTING GROUNDCOVER, OR DIRECT SEEDING APPLICATIONS.
 4. FIVE PERCENT (5%) OF THE TOTAL SITE SHOULD BE LEFT UN-MULCHED FOR BURROWING BEE HABITAT.



SANTA ROSA JUNIOR COLLEGE
DEMONSTRATION GARDEN PROJECT
425 ELLIOTT AVE FRONT
SANTA ROSA, CA



LAYOUT AND PLANTING PLAN
THEME:
FIRE SAFER STRATEGIES

DATE
JUNE, 2018

H-2.0

SHEET 2
OF 3